

SEDM EI 120 S (In Vertical Duct)

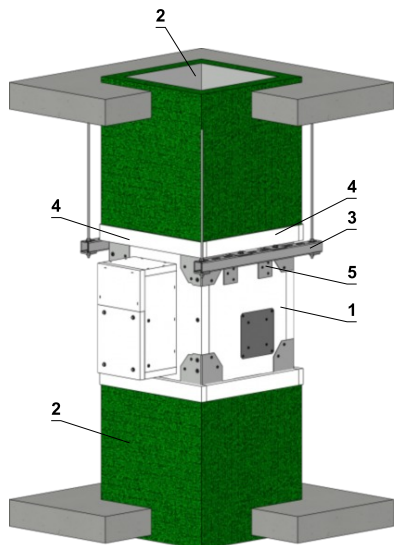

- 1 SEDM
- 2 Duct
- 3 Fixing profile with threaded rod
- 4 Connection's insulation
- 5 L-holder

Note: Brackets must be mounted on sides, location and symmetry is not a specific requirement but is preferential.

The dampers must be suspended using threaded rods and mounting profiles. Their dimensioning depends on the damper's weight.

The dampers and duct must be suspended separately. The connected duct must be suspended in such a way that the transfer of all loads from the adjoining ventilation duct to the damper body is completely excluded. Adjacent duct must be suspended or supported, as required by the duct suppliers.

Threaded rods longer than 1.5 m must be protected by fire insulation.

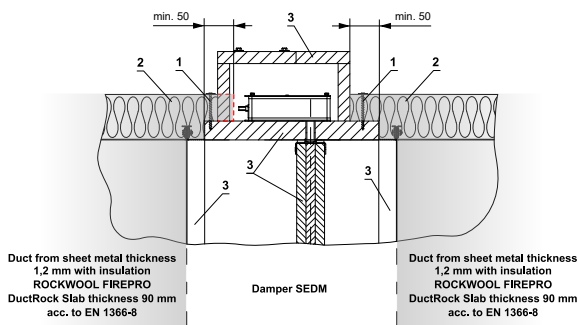

Insulation cut-out area around the actuator cover

Connect the joints of stone wool plates with ROCKWOOL Glue, secure with nails and welding pins at max. spacings of 250mm. Board joints must be covered using ROCKWOOL black aluminium foil tape. Follow duct supplier's instructions and insulation.

Position:

1. Universal screw min. Ø5 mm, length 70 mm, max. spacing 250 mm
2. ROCKWOOL FIREPRO DuctRock Slab th. 90 mm acc. to EN 1366-8
3. Part of SEDM
4. Welding pins at max. spacings of 250 mm

Removable actuator cover

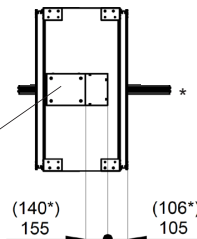

Drop rod and hanger location, please ensure that actuator operation is not compromised and ensure sufficient space to allow access hatch removal.

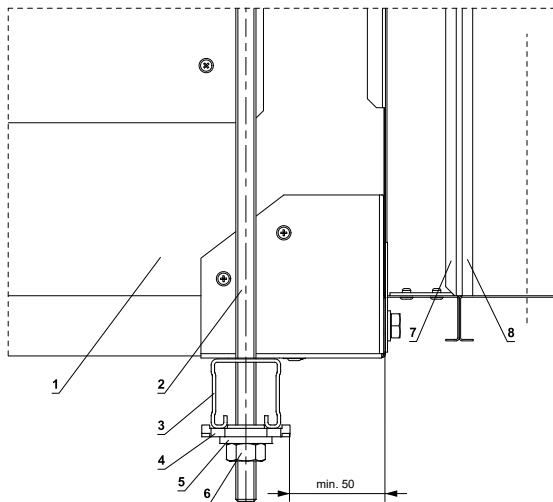

Drop rod and hanger position is not critical and can be positioned to suit the particular installation, applying symmetry where possible.

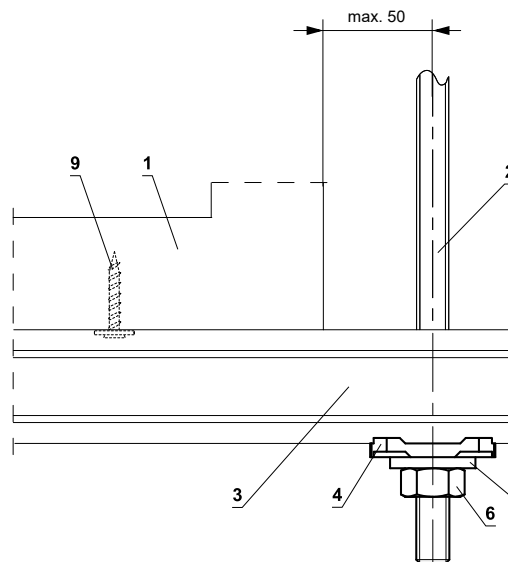

- 1 SEDM
- 2 Threaded rod M8 - M20
- 3 Support HILTI MQ-41 (or MQ-41/3 or equivalent)
- 4 Bored plate HILTI MQZ-L or equivalent
- 5 Washer for M8 - M20
- 6 Nut M8 - M20
- 7 Flange of SEDM
- 8 Flange of duct
- 9 Self-tapping screw 5x30 mm and 1 pcs large washer M5 (for additional fixing, prevents the damper from sliding off the support - not necessary use)

Advice provided by a fixing specialist contractor takes precedence.

Examples of anchoring to the ceiling construction
Follow the instructions of fixing specialist or installation company

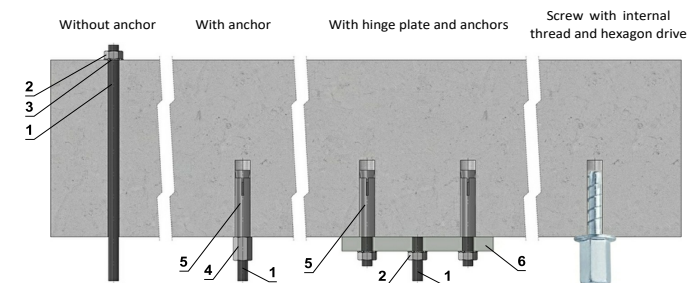

Hinge plates

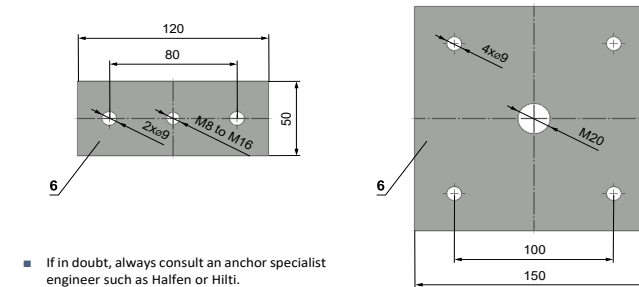

Load capacities of threaded rods at the required fire resistance 60 min. < t ≤ 120 min.

Size	As [mm²]	Weight [kg]	
		for 1 rod	for 2 rods
M8	36,6	22	44
M10	58	35	70
M12	84,3	52	104
M16	157	96	192
M18	192	117	234
M20	245	150	300

Drop rod diameter is based on damper weight, see full Damper TPM for further technical details or contact help@Mandik.co.uk. Mandik reserves the right to update this information without prior notice.

MANDIK®

Mandik UK Ltd
www.mandik.co.uk
Office: 0117 4526376
2440 The Quadrant
Aztec West
Bristol
BS32 4AQ

Title:	SEDM - In Vertical Duct		UKCA certified acc. to EN 12101-8	
Classification:	EI 120 (hod-ved i<->o) S1000CmodHOT 400/30MAmulti		Tested in accordance with EN 1366-10	
			Size: (min-max)	180x180 - 1600x1000
Drawing No:	0000-0000-550 Rev 3		Date: 06/01/2025	
			Illustrated: AA	Approved: MF

Intellectual property of MANDIK Ltd. Unauthorised use shall be punishable by law